

AutoClip™ EDH25



 **EnviroClip™**
DUO



**Stand Alone, Flexible,
Intermittent Motion Machine**
Designed to Place Clips
onto Jars and Bottles

AutoClip™ EDH25

The AutoClip™ EDH25 is a stand-alone, flexible, intermittent motion machine designed for picking and placing the EnviroClip™ Duo onto glass and plastic jars and bottles at the front end of a production line.

Machine Features

Standard

- Multiple sizes to suit application.
- Various drive options for greater flexibility and ability to pick products that were challenging in the past.
- Casters for mobility and adjustable foot pads.
- PLC controlled – brand flexibility allows flexible configurations.
- Drives, vacuum generators, and bearings that have been proven to be long lasting.

Optional

- Quick-change magazine and vacuum stem assemblies for quick, repeatable changeovers.
- Multi-Lane, stacked magazines.
- Mechanical grippers.
- Line controls to meet customer needs.
- Signal options: Photo eye, batch counter, fixed cycle rate signal, timer to signal, encoder or customer to signal.
- Low magazine or missed item signal options.
- Carts for quick-change magazines and tooling.
- Swivel HMI station.
- Bar code reader and verification.
- Drive – Servo or Pneumatic.
- Vacuum pump filters.

Functional Design, Easy Access Construction:

- Heavy-duty cold rolled steel frame with Melonite coating.
- Three construction grades to match application needs, including water resistant/wash-down.
- Clear visibility and easy-access guarding provide access to machine.

Range of Product

- Product size dependent upon machine width and pick arm size.
- Plastic and glass jars and bottles: Height 5" to 8". Diameter 3" to 4".

Specifications

Speed

- Up to 25 cycles per minute per lane.
- Speed is dependent upon product characteristics.

Product Configuration

- Multiple magazine lanes to provide higher output.
- Magazine lanes perpendicular to flow or in-line with flow.

Machine Models

- 12" and 24" wide standard models, custom widths available.

Electrical

- Control Voltage: 24 VDC.
- Supply Voltage: 120 VAC. (220/460 VAC optional)

Air Requirements

- 80 PSI clean/dry air.

Weight

Approx. 800lbs.

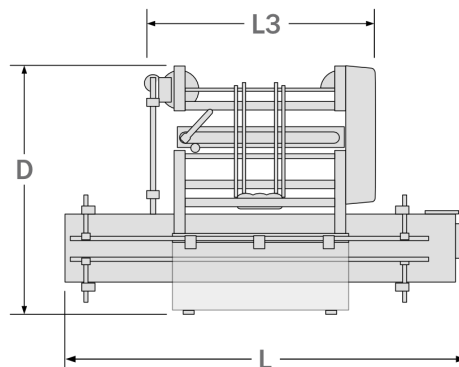
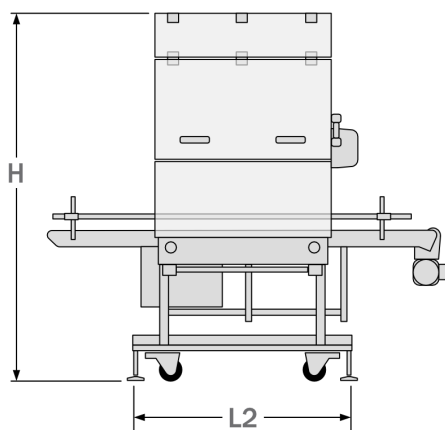

L	74"
	1870 mm
L2	40"
	1026 mm
L3	42"
	1068 mm
D	47"
	1194 mm
H	67"
	1711 mm